

TYPICAL 8' GRAVITY WALL SECTION W/ 2:1 BACKSLOPE

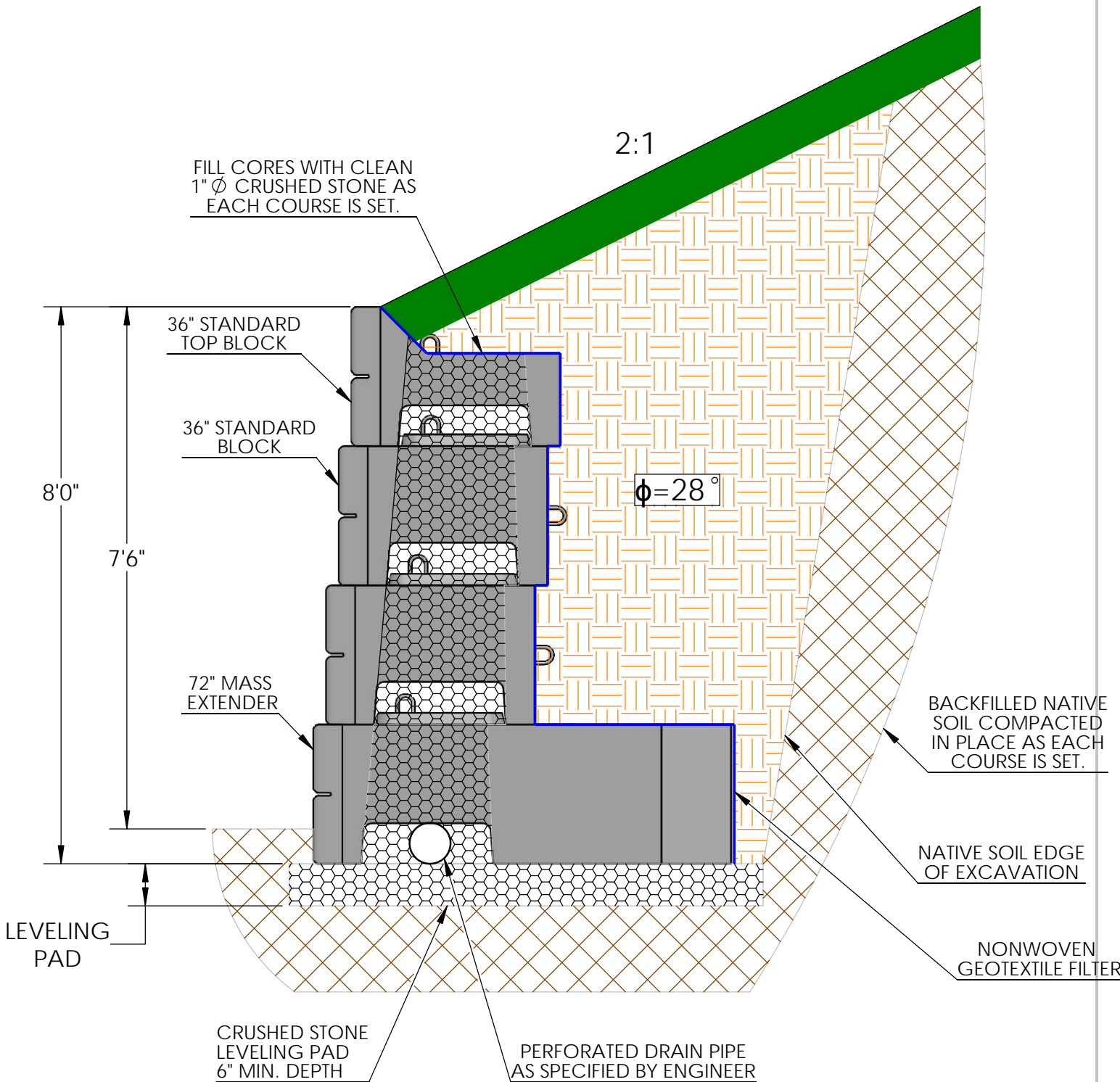

Note: This drawing was prepared by Verti-Crete, LLC for estimating and conceptual design purposes only. All information in believed to be true and accurate; however Verti-Crete, LLC assumes no responsibility for the use of this drawing for actual construction. Determination of the suitability of each drawing is the sole responsibility of the user. Final designs for construction purposes must be performed by a registered Professional Engineer, using the actual conditions of the proposed site.



DRAWN BY
R FONTANESI

DATE
1/10/2018

DWG NO.

GW-72

16500 SOUTH 500 WEST
BLUFFDALE, UTAH 84065
PHONE: (801) 571-2028

TITLE: TYPICAL 8' GRAVITY WALL SECTION
SILTY SOIL (28°)
2:1 BACKSLOPE, NO SURCHARGE