

# TYPICAL 8' GRAVITY WALL SECTION W/ 2:1 BACKSLOPE

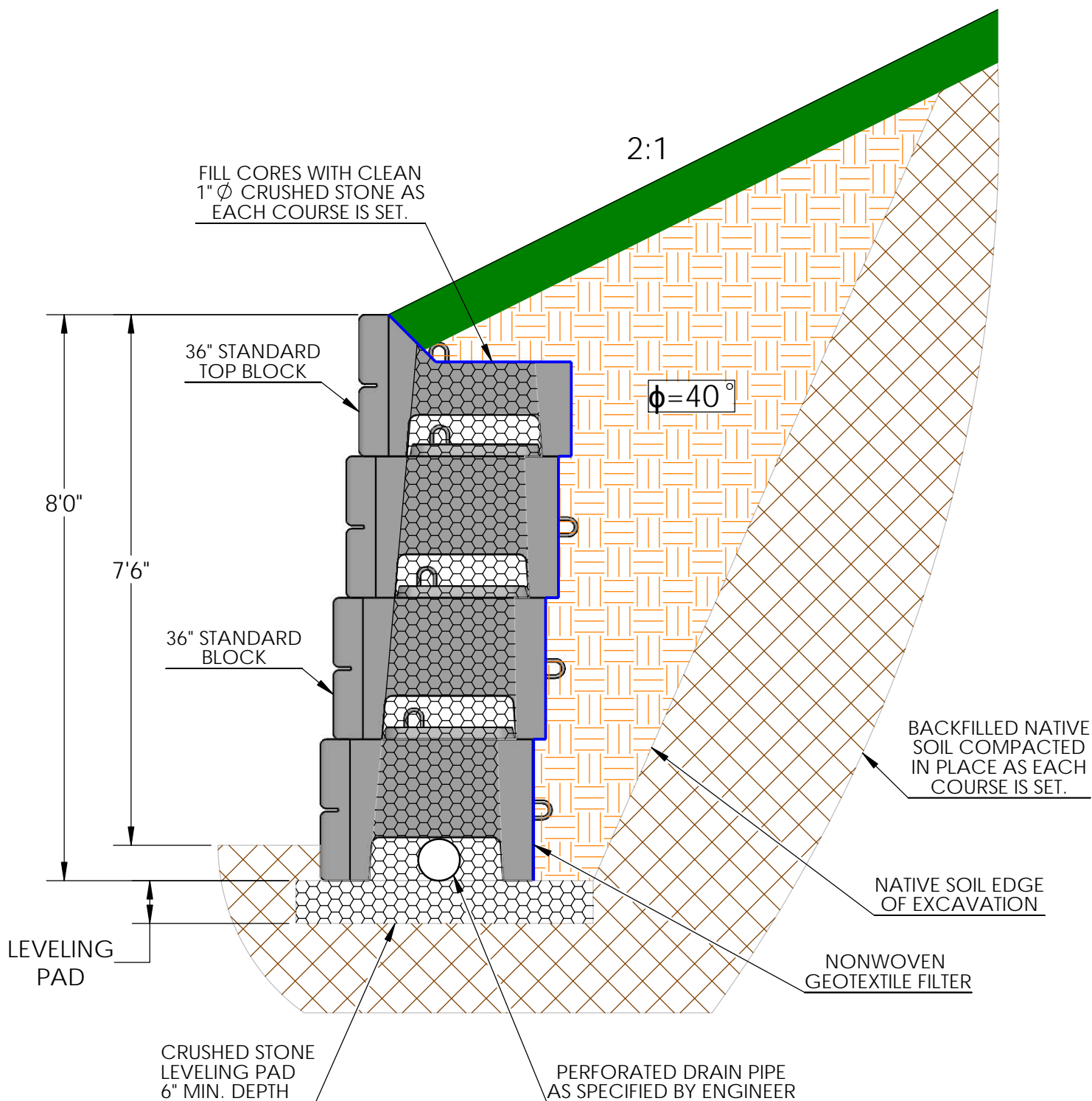

Note: This drawing was prepared by Verti-Crete, LLC for estimating and conceptual design purposes only. All information in believed to be true and accurate; however Verti-Crete, LLC assumes no responsibility for the use of this drawing for actual construction. Determination of the suitability of each drawing is the sole responsibility of the user. Final designs for construction purposes must be performed by a registered Professional Engineer, using the actual conditions of the proposed site.



DRAWN BY  
R FONTANESI

DATE  
12/28/2017

DWG NO.

GW-90

TITLE:  
TYPICAL 8' GRAVITY WALL SECTION  
GRAVELY SOIL (40°)  
2:1 BACKSLOPE, NO SURCHARGE

16500 SOUTH 500 WEST  
BLUFFDALE, UTAH 84065  
PHONE: (801) 571-2028